

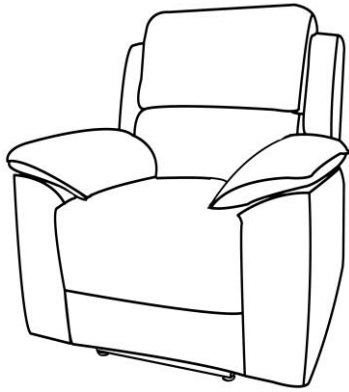

# **ASSEMBLY INSTRUCTIONS**

**GOODWOOD FABRIC  
ELECTRIC RECLINER  
ARMCHAIR**



Please follow these instructions carefully in order to ensure your chair is assembled in the correct manner.

Please do not use a sharp implement when unpacking your furniture as this may damage the fabric.

Please note that any creases in the fabric are as a result of the packaging and are perfectly normal. These will diminish over the first few weeks of use at room temperature.

#### STEP 1

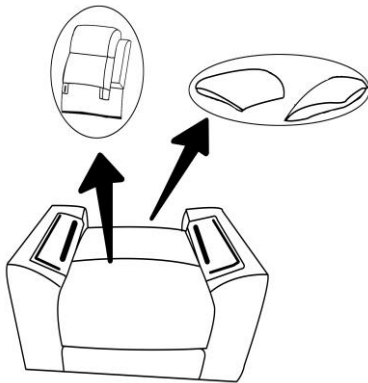

Remove the back cushion and arm pads from the chair, as shown above.

#### STEP 2

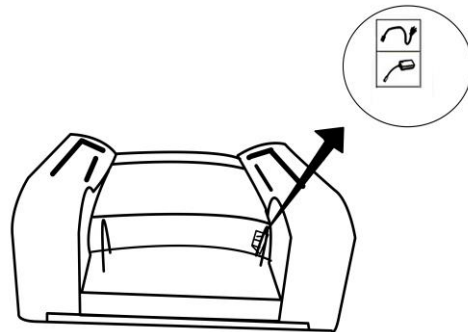

Remove the bag of electrics from the connecting clip on the back of the chair.

#### STEP 3

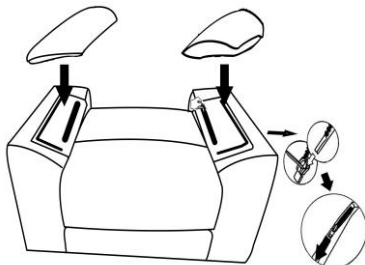

Remove the protective backing cloth from the Velcro strips, position the arms using the Velcro to secure in place and attach with the zip, as shown above.

#### STEP 4

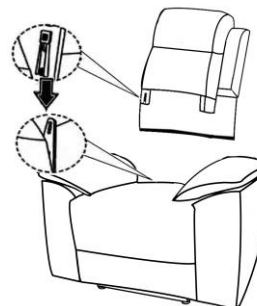

When fitting sofa backs ensure the connecting clips are aligned and then lower the back section into the base applying firm pressure until you hear a 'click' and the back is secure.

#### STEP 5

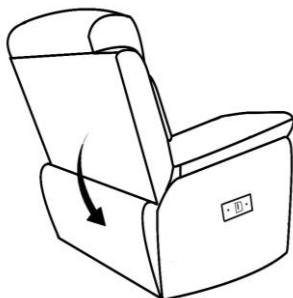

Attach the back cover to the velcro strip at the bottom to secure.

#### STEP 6

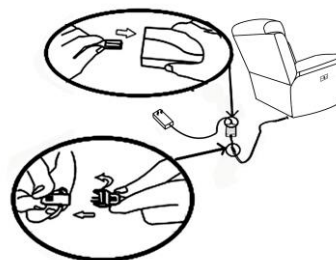

Connect the power as shown above.

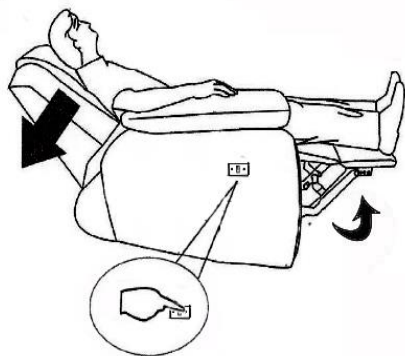
**STEP 7**

Press the front button to recline your furniture.

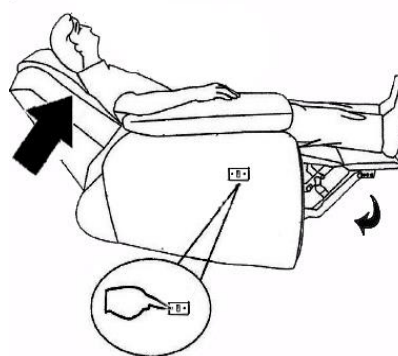
**STEP 8**

Press the rear button to return to the upright position.

**STEP 9**

Please do not sit on the foot rest!

**STEP 10**

Please do not sit on the arm rest!

\*Failure to correctly assemble your furniture may affect your warranty



# **ASSEMBLY INSTRUCTIONS**

**GOODWOOD FABRIC  
2 SEATER ELECTRIC  
RECLINER SOFA**

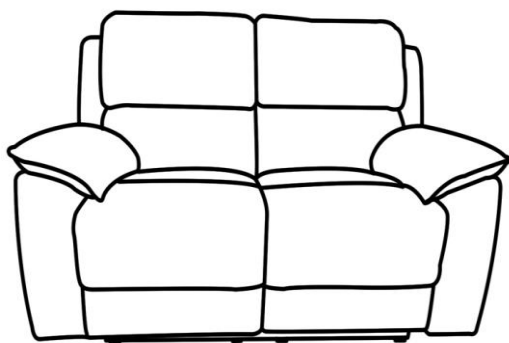

Please follow these instructions carefully in order to ensure your sofa is assembled in the correct manner.

Please do not use a sharp implement when unpacking your furniture as this may damage the fabric.

Please note that any creases in the fabric are as a result of the packaging and are perfectly normal. These will diminish over the first few weeks of use at room temperature.

#### STEP 1

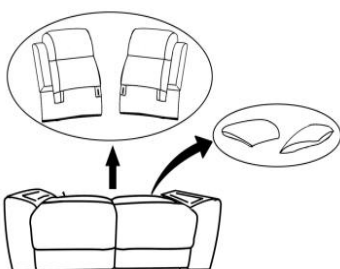

Remove the back cushions and arm pads from the sofa, as pictured above.

#### STEP 2

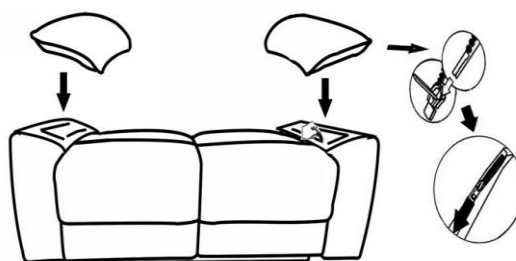

Remove the protective backing cloth from the Velcro strips, position the arms using the Velcro to secure in place and to attach with the zip as shown.

#### STEP 3

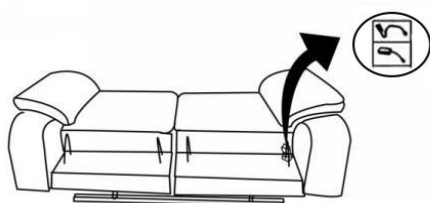

Remove the bag of electrics from the connecting clip on the back of the sofa.

#### STEP 4

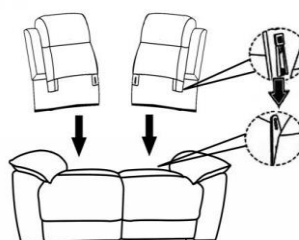

When fitting sofa backs ensure the connecting clips are aligned and then lower the back section into the base applying firm pressure until you hear a 'click' and the back is secure.

#### STEP 5

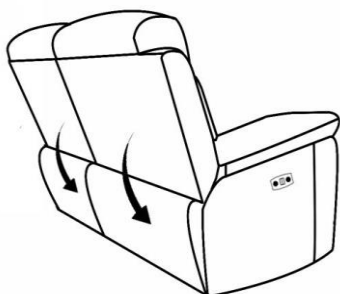

Attach the back cover to the velcro strip at the bottom to secure.

#### STEP 6

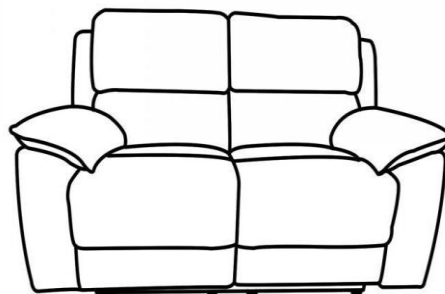

Your sofa should now be fully assembled.

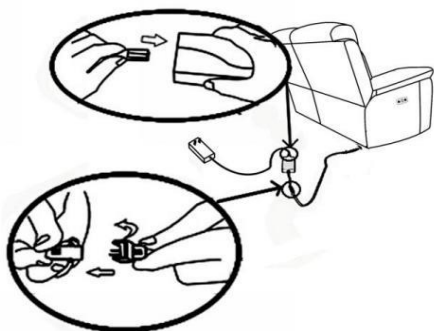
**STEP 7**

Connect the cables from the sofa into the transformers provided and plug into a standard mains socket as diagram above.

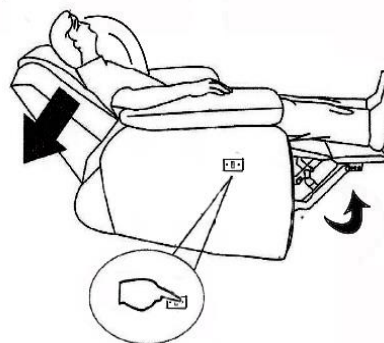
**STEP 8**

Press the front button to recline your furniture.

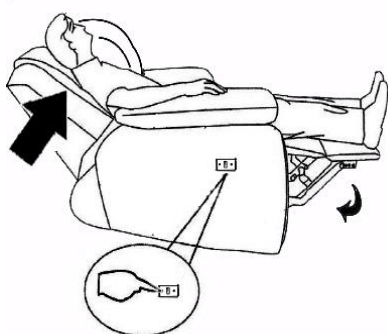
**STEP 9**

Press the rear button to return to the upright position.

**STEP 10**

Please do not sit on the foot rest!

\*Failure to correctly assemble your furniture may affect your warranty



# **ASSEMBLY INSTRUCTIONS**

**GOODWOOD FABRIC  
3 SEATER ELECTRIC  
RECLINER SOFA**

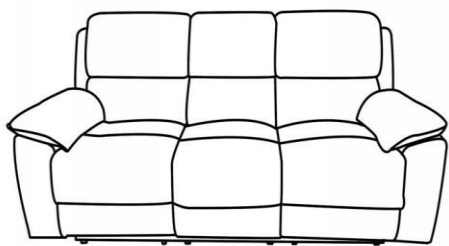

Please follow these instructions carefully in order to ensure your sofa is assembled in the correct manner.

Please do not use a sharp implement when unpacking your furniture as this may damage the fabric.

Please note that any creases in the fabric are as a result of the packaging and are perfectly normal. These will diminish over the first few weeks of use at room temperature.

#### STEP 1

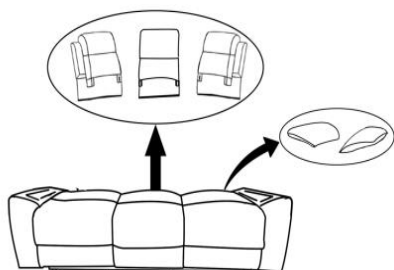

Remove the cushions and arm pads from the sofa as pictured above.

#### STEP 2

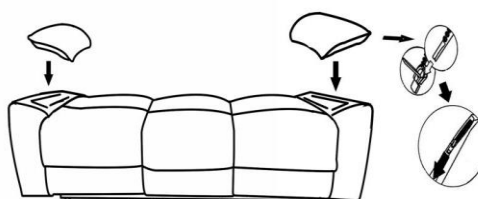

Remove the protective backing cloth from the Velcro strips, position the arms using the Velcro to secure in place and attach with the zip as shown.

#### STEP 3

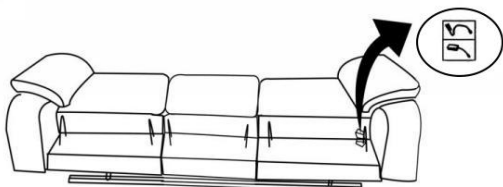

Remove the bag of electrics from the connecting clip on the back of the sofa.

#### STEP 4

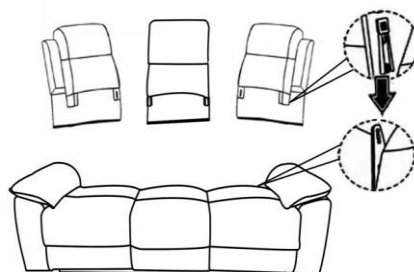

When fitting sofa backs ensure the connecting clips are aligned and then lower the back section into the base applying firm pressure until you hear a 'click' and the back is secure.

#### STEP 5

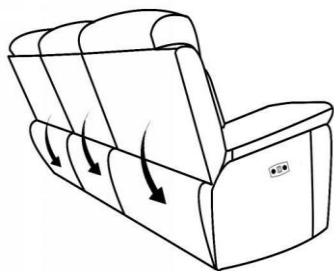

Attach the back cover to the velcro strip at the bottom to secure.

#### STEP 6

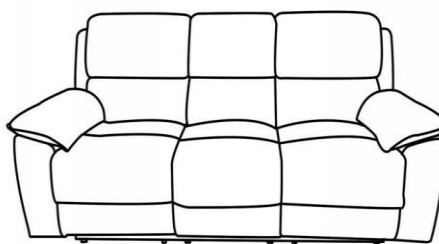

Your sofa should now be fully assembled.

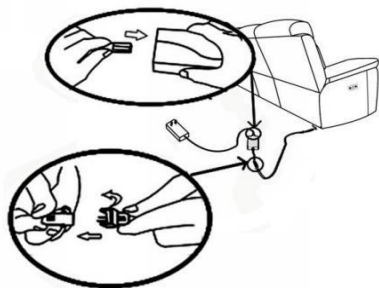

**STEP 7**

Connect the cables from the sofa into the transformers provided and plug into a standard mains socket as diagram above.

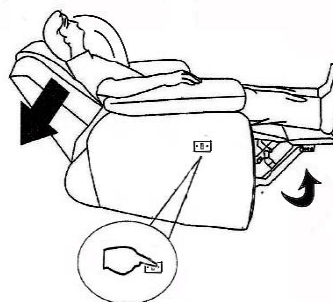
**STEP 8**

Press the front button to recline your furniture.

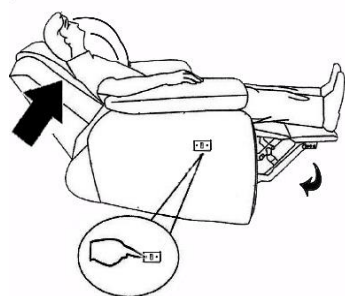
**STEP 9**

Press the rear button to return to the upright position.

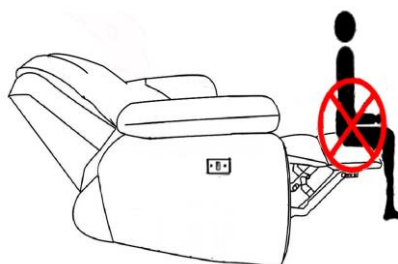
**STEP 10**

Please do not sit on the foot rest!

\*Failure to correctly assemble your furniture may affect your warranty



# **ASSEMBLY INSTRUCTIONS**

**GOODWOOD LEATHER  
ELECTRIC RECLINER  
ARMCHAIR**

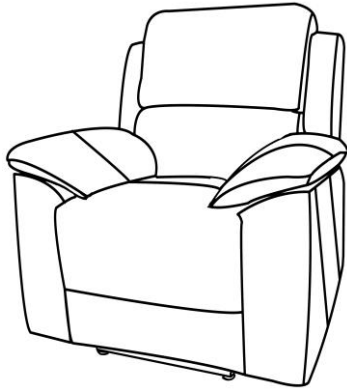

Please follow these instructions carefully in order to ensure your chair is assembled in the correct manner.

Please do not use a sharp implement when unpacking your furniture as this may damage the fabric.

Please note that any creases in the fabric are as a result of the packaging and are perfectly normal. These will diminish over the first few weeks of use at room temperature.

#### STEP 1

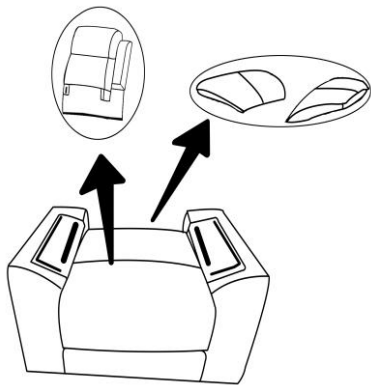

Remove the back cushion and arm pads from the chair, as shown above.

#### STEP 2

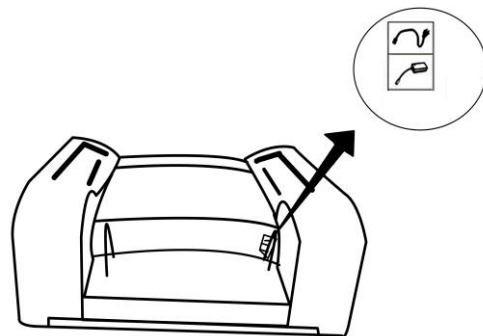

Remove the bag of electrics from the connecting clip on the back of the chair.

#### STEP 3

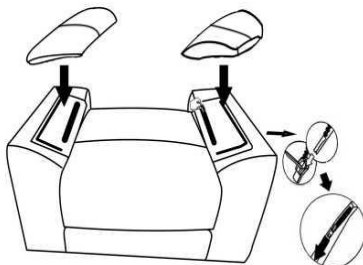

Remove the protective backing cloth from the Velcro strips, position the arms using the Velcro to secure in place and attach with the zip, as shown above.

#### STEP 4

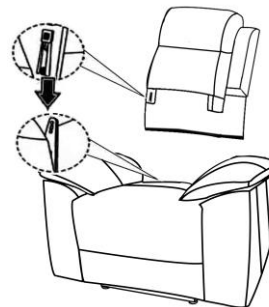

When fitting sofa backs ensure the connecting clips are aligned and then lower the back section into the base applying firm pressure until you hear a 'click' and the back is secure.

#### STEP 5

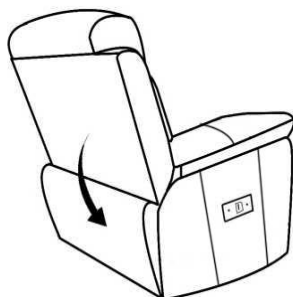

Attach the back cover to the velcro strip at the bottom to secure.

#### STEP 6

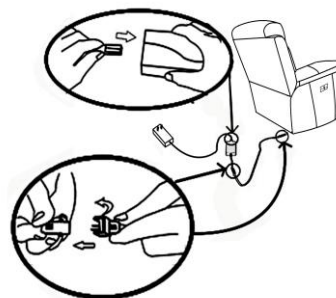

Connect the power as shown above.

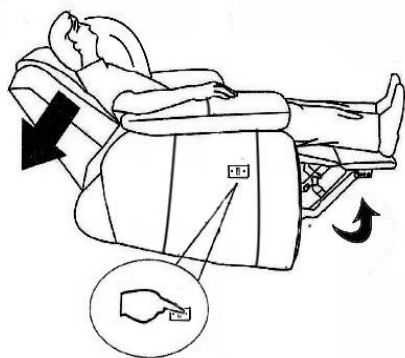
**STEP 7**

Press the front button to recline your furniture.

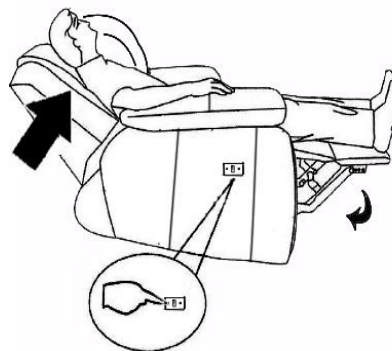
**STEP 8**

Press the rear button to return to the upright position.

**STEP 9**

Please do not sit on the foot rest!

**STEP 10**

Please do not sit on the arm rest!

\*Failure to correctly assemble your furniture may affect your warranty



# **ASSEMBLY INSTRUCTIONS**

**GOODWOOD LEATHER  
2 SEATER ELECTRIC  
RECLINER SOFA**

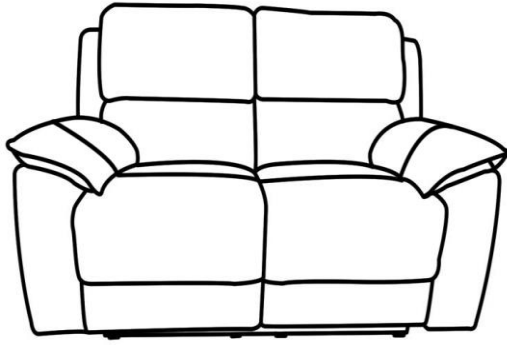

Please follow these instructions carefully in order to ensure your sofa is assembled in the correct manner.

Please do not use a sharp implement when unpacking your furniture as this may damage the fabric.

Please note that any creases in the fabric are as a result of the packaging and are perfectly normal. These will diminish over the first few weeks of use at room temperature.

#### STEP 1

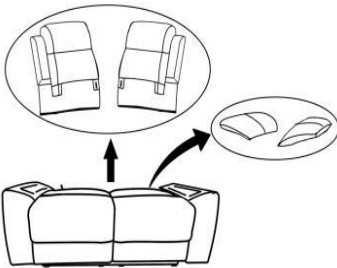

Remove the back cushions and arm pads from the sofa, as pictured above.

#### STEP 2

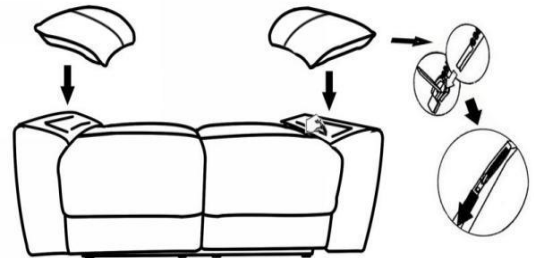

Remove the protective backing cloth from the Velcro strips, position the arms using the Velcro to secure in place and to attach with the zip.

#### STEP 3

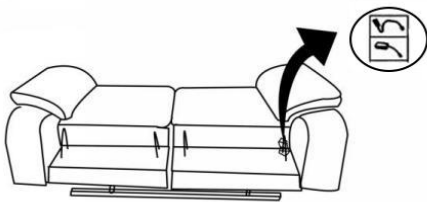

Remove the bag of electricals from the connecting clip on the back of the sofa.

#### STEP 4

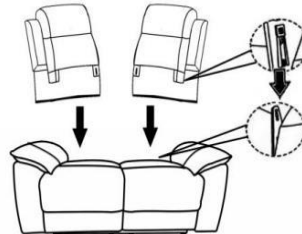

When fitting sofa backs ensure the connecting clips are aligned and then lower the back section into the base applying firm pressure until you hear a 'click' and the back is secure.

#### STEP 5

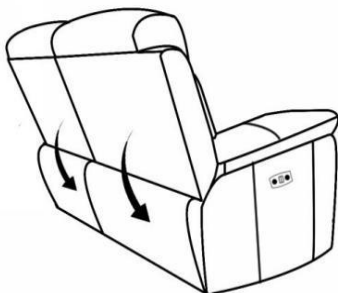

Attach the back cover to the velcro strip at the bottom to secure.

#### STEP 6

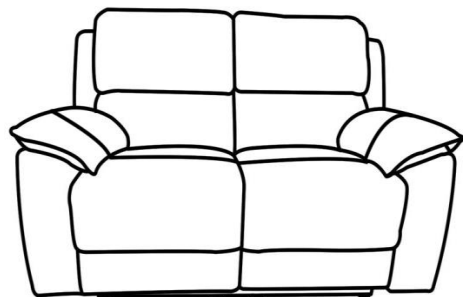

Your sofa should now be fully assembled.

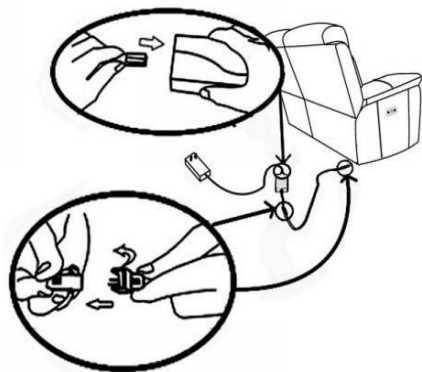
**STEP 7**

Connect the cables from the sofa into the transformers provided and plug into a standard mains socket, as diagram above.

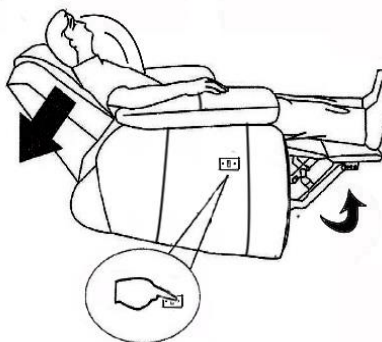
**STEP 8**

Press the front button to recline your furniture.

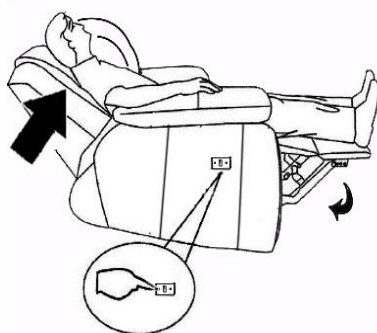
**STEP 9**

Press the rear button to return to the upright position.

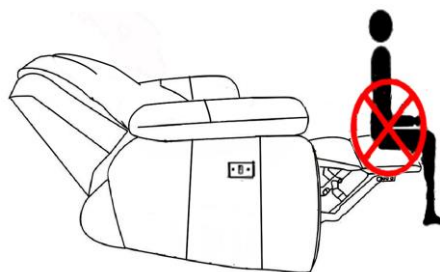
**STEP 10**

Please do not sit on the foot rest!

\*Failure to correctly assemble your furniture may affect your warranty



# **ASSEMBLY INSTRUCTIONS**

**GOODWOOD LEATHER  
3 SEATER ELECTRIC  
RECLINER SOFA**



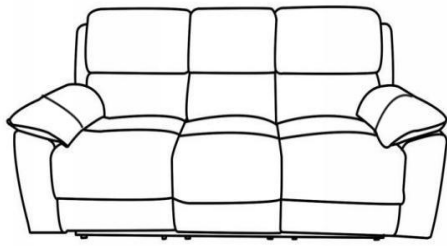

Please follow these instructions carefully in order to ensure your sofa is assembled in the correct manner.

Please do not use a sharp implement when unpacking your furniture as this may damage the fabric.

Please note that any creases in the fabric are as a result of the packaging and are perfectly normal. These will diminish over the first few weeks of use at room temperature.

#### STEP 1

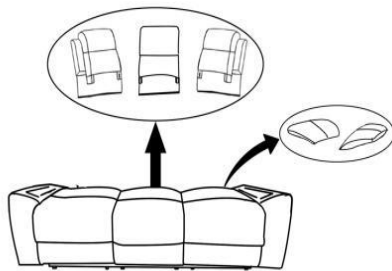

Remove the cushions and arm pads from the sofa, as pictured above.

#### STEP 2

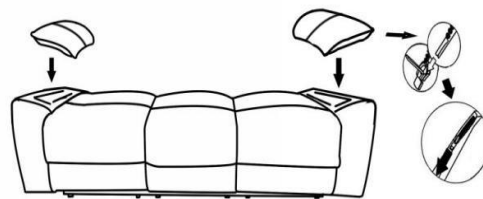

Remove the protective backing cloth from the Velcro strips, position the arms using the Velcro to secure in place and attach with the zip as shown.

#### STEP 3

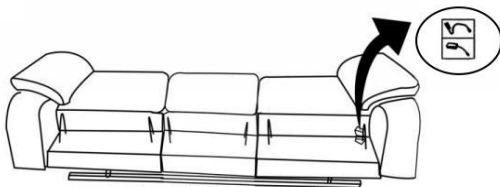

Remove the bag of electrics from the connecting clip on the back of the sofa.

#### STEP 4

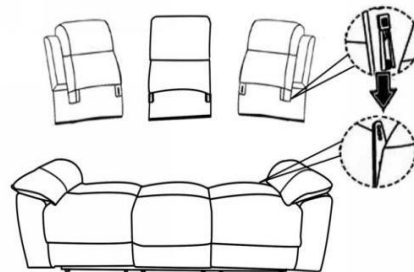

When fitting sofa backs ensure the connecting clips are aligned and then lower the back section into the base applying firm pressure until you hear a 'click' and the back is secure.

#### STEP 5

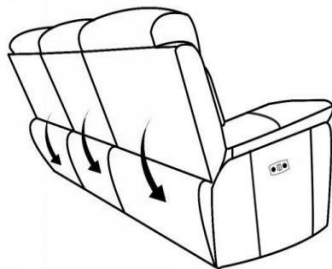

Attach the back cover to the velcro strip at the bottom to secure.

#### STEP 6

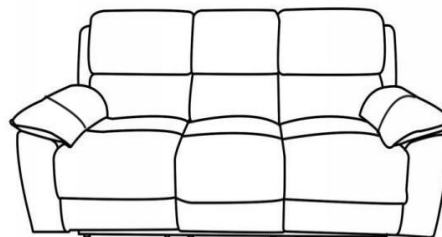

Your sofa should now be fully assembled.

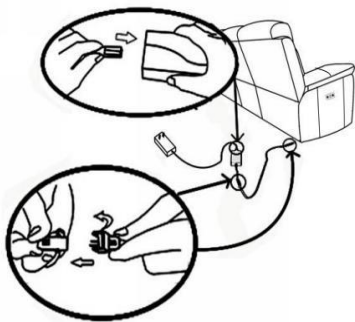
**STEP 7**

Connect the cables from the sofa into the transformers provided and plug into a standard mains socket as diagram above.

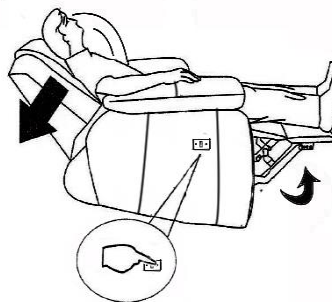
**STEP 8**

Press the front button to recline your furniture.

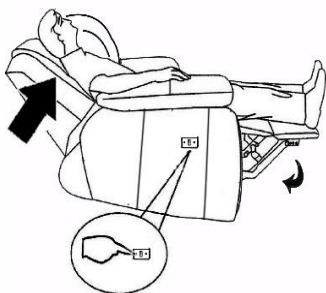
**STEP 9**

Press the rear button to return to the upright position.

**STEP 10**

Please do not sit on the foot rest!

\*Failure to correctly assemble your furniture may affect your warranty



# **ASSEMBLY INSTRUCTIONS**

**GOODWOOD  
MODULAR CORNER SOFA**

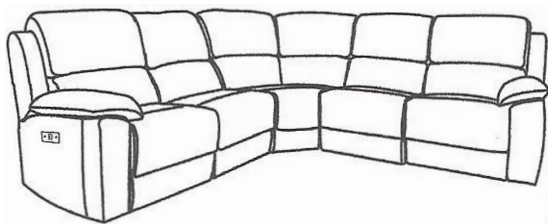

Please follow these instructions carefully in order to ensure your sofa is assembled in the correct manner.

Please do not use a sharp implement when unpacking your furniture as this may damage the fabric.

Please note that any creases in the fabric are as a result of the packaging and are perfectly normal. These will diminish over the first few weeks of use at room temperature.

#### STEP 1

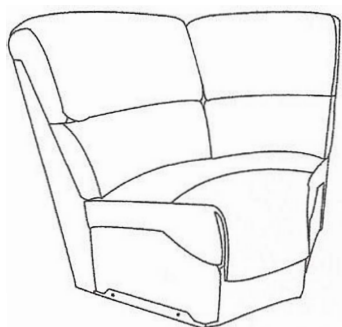

Image of the Corner Section of the Goodwood Sofa.

#### STEP 2

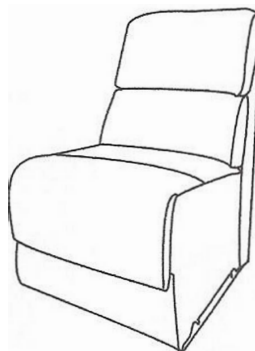

Image of the armless Section of the Goodwood Sofa.

#### STEP 3

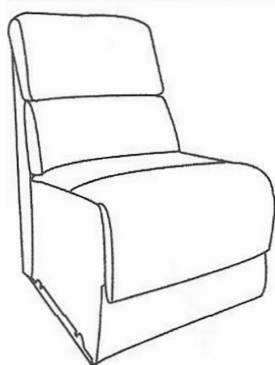
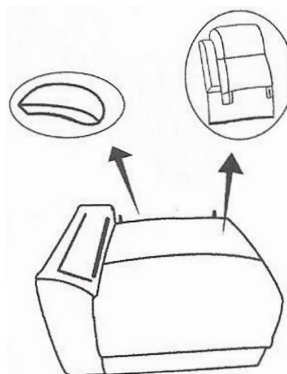

Image of the second armless Section of the Goodwood Sofa.

#### STEP 4



Remove the back cushion and arm pad from the left arm section of the sofa, as shown above.

#### STEP 5

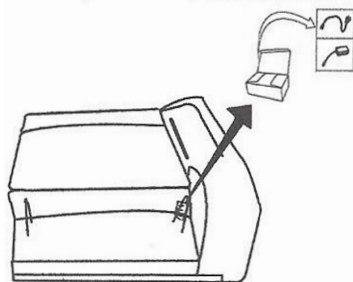

Remove the box of electrics from the connecting clip on the back of the arm section piece.

#### STEP 6

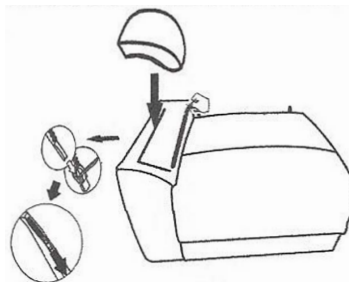

Remove the protective backing cloth from the Velcro strips, position the arms using the Velcro to secure in place and then attach with the zip, as shown above.

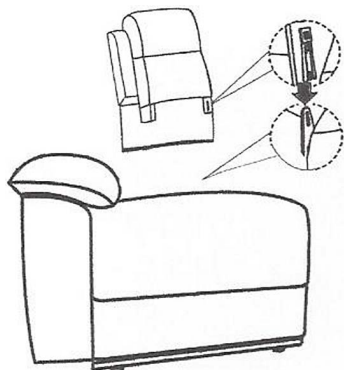
**STEP 7**

When fitting sofa backs ensure the connecting clips are aligned and then lower the back section into the base applying firm pressure until you hear a 'click' and the back is secure.

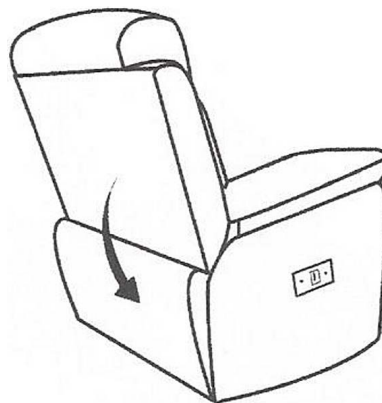
**STEP 8**

Attach the back cover to the velcro strip at the bottom to secure.

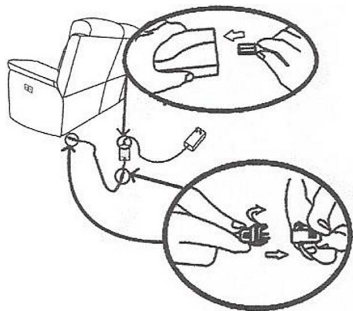
**STEP 9**

Connect the power as shown.

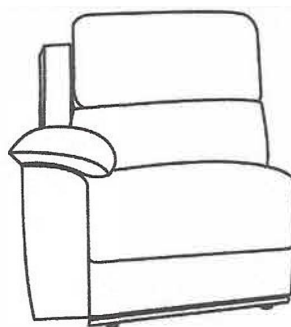
**STEP 10**

Your fully assembled arm section, should now look like this.

**STEP 11**

Repeat the above process to assemble the Right arm section of the Goodwood sofa.

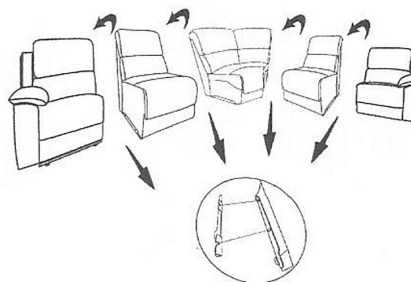
**STEP 12**

Connect the sofa parts as shown in the diagram above.

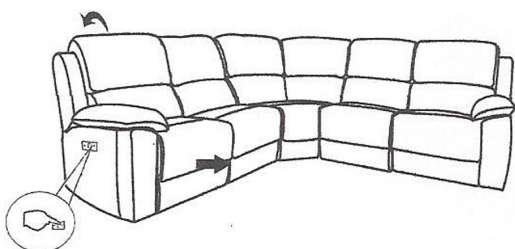
**STEP 13**

Press the front button to recline your furniture.

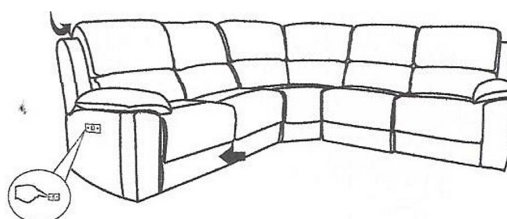
**STEP 14**

Press the back button to return to the upright position.

**STEP 15**

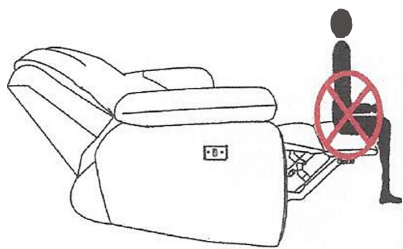

Please do not sit on the footrest

**STEP 16**

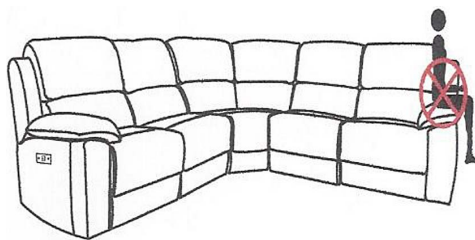

Please do not sit on the arm rest

\*Failure to correctly assemble your furniture may affect your warranty